

- ① 在車頭上固定好安裝架(a)  
Fixing the base (a) on the sewing machine

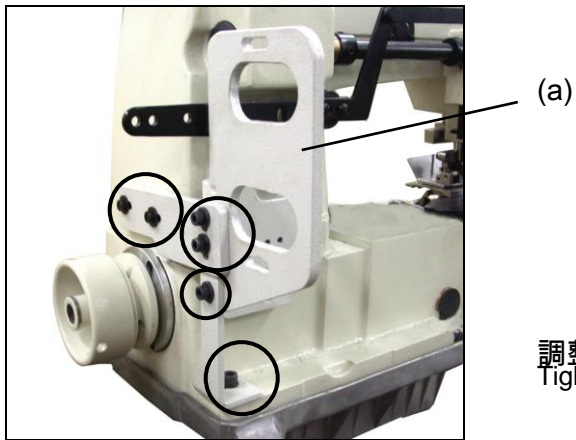

- ② 安裝變速機於主架上  
The Transmission installing to the base

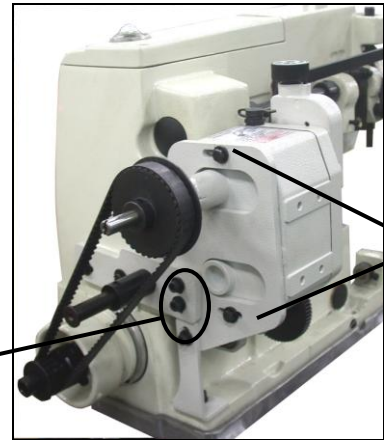

- ③ 安裝皮帶輪(b)並加上皮帶蓋  
Installing the pulleys (b) and the belt covering

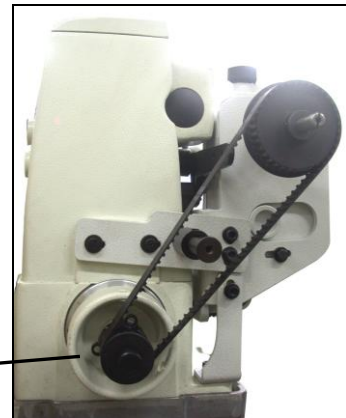
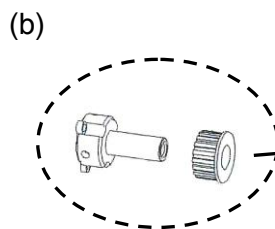

- ④ 變速機的紅線對齊入立軸紅線後，上緊時規齒輪螺絲  
Meet the both red line on transmission input shaft,  
tighten the timing gear screw

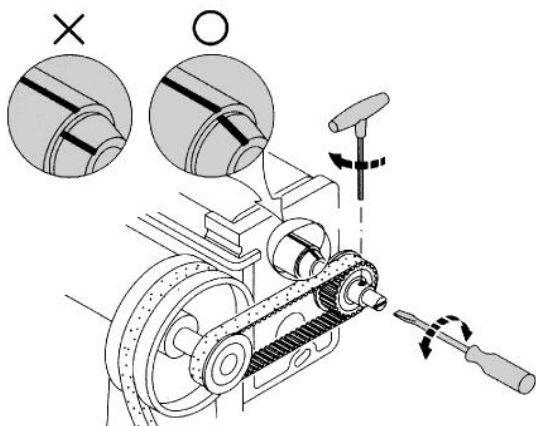

### 入力軸定位

#### Adjust input shaft position

一般針車定位時，  
針車提升至最高點  
General type, needle  
to the toppest position

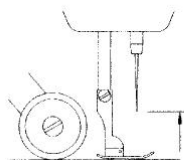

針送針車定位時，  
針車下降至最低點  
Needle feed type, needle  
to the lowest position

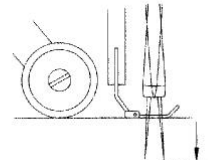

- ④ 固定上、下拖輪架(c) (d)  
Fix the pullers (c) (d)

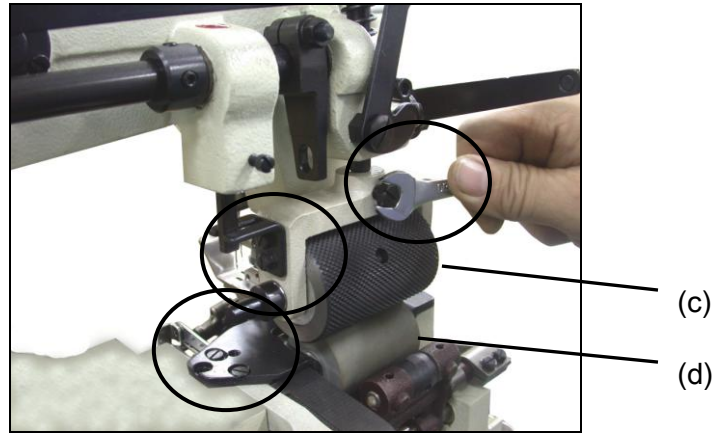

- ⑤ 固定上、下連接桿(e) (f)  
Fix the connecting rods (e) (f)

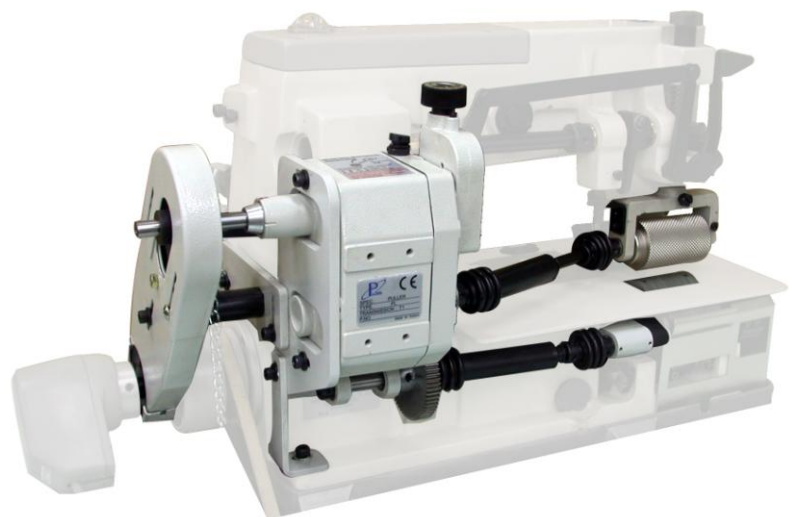
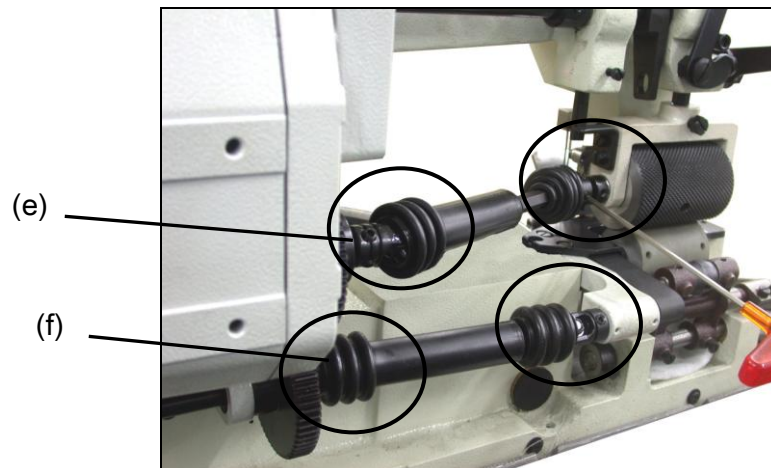

# 接線圖 WIRING DIAGRAM

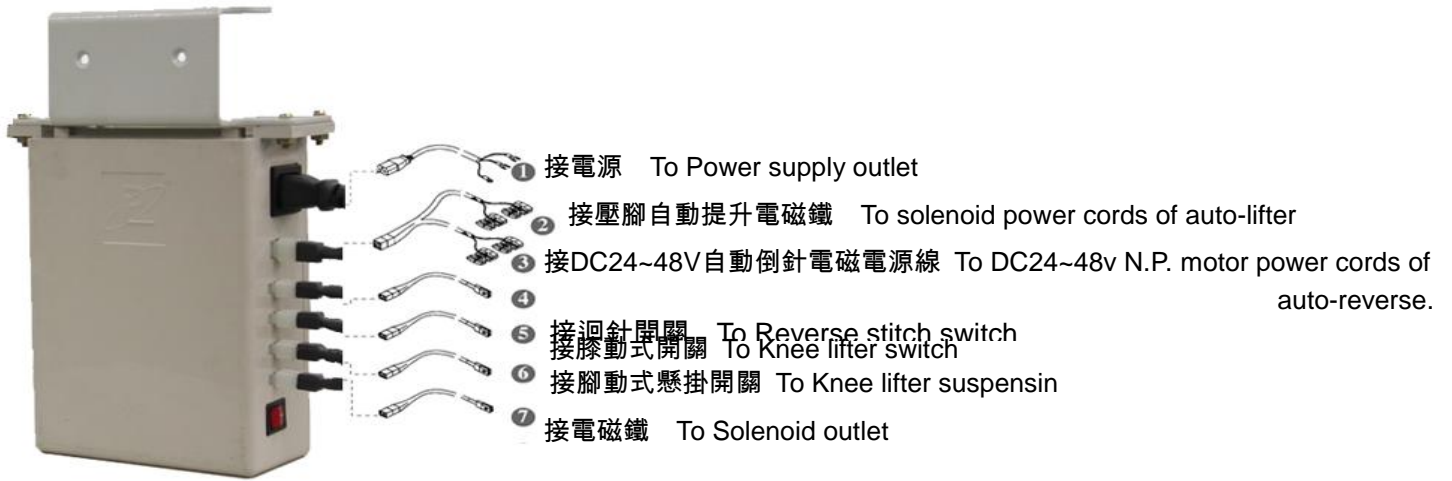

**1** 電源線及地線(電源：AC100V~220VC)  
power cords and earth terminal  
(AC100V~220VC power source)

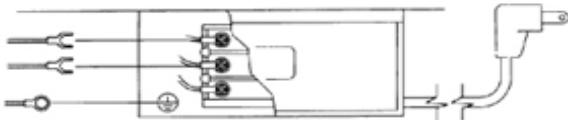

**2** 接壓腳自動提升電磁鐵電源線

To solenoid power cords of auto-lifer

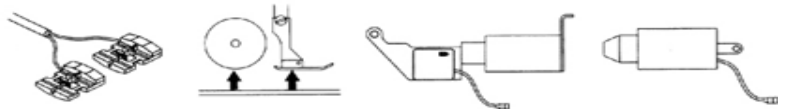

**3** 接於自動切線針車倒針用電磁電源上(DC24~48V)

Finding and connecting the power cords of auto-reverse

無自動切線之針車此線無需使用並將蓋子蓋上

For nonautomatic-trimming machine,keep this wire connecter

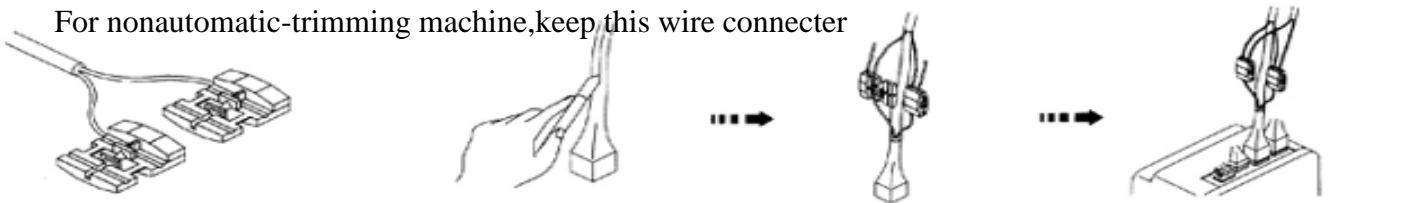

**4** 迴針開關

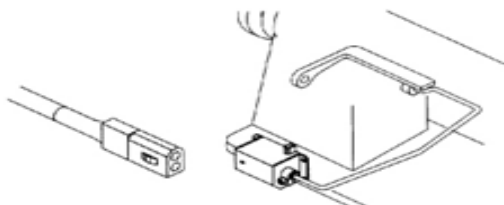

**5** 膝動開關

Microswitch for knee pressed foot lifter

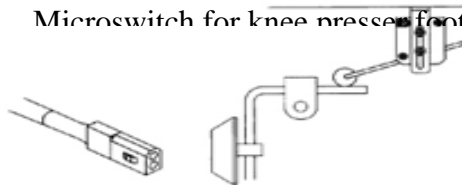

**6** 懸吊式開關

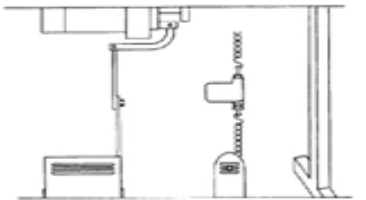

**7** 電磁鐵  
Solenoid

