

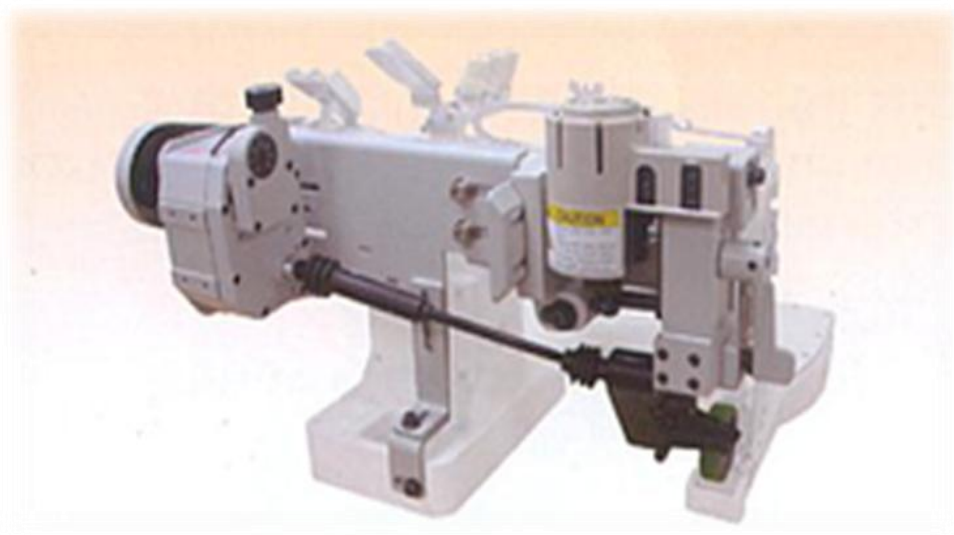

# HPF 腕型車用拖輪安裝手冊 THE INSTRUCTION GUIDE BOOK FOR HPF PULLER



安裝前,請詳細閱讀安裝說明書

PLEASE READ INSTRUCTIONS & ASSOCIATED DRAWINGS BEFORE INSTALLATION

- ① 在車頭上固定好安裝架  
Fixing the base on the sewing machine

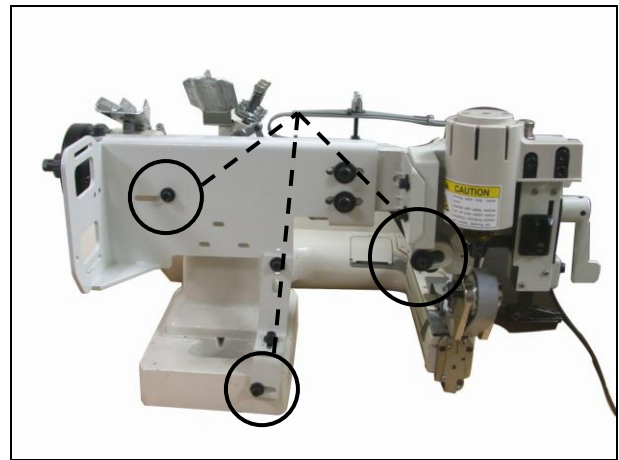
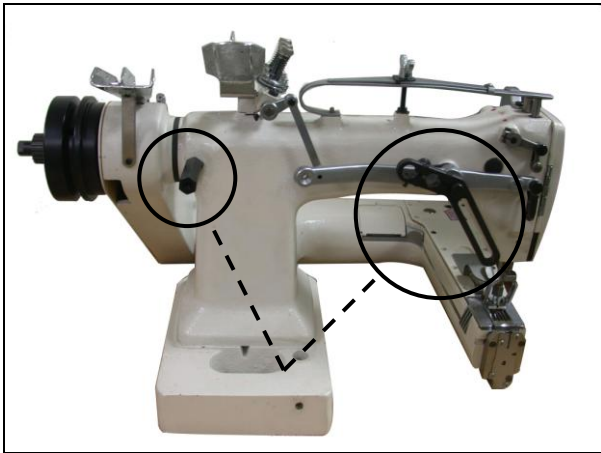

- ② 安裝皮帶輪  
Installing the pulleys

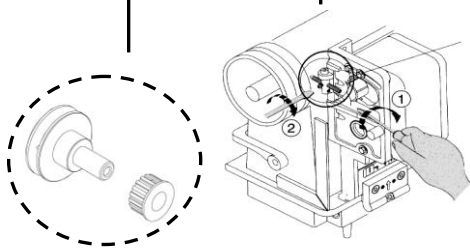
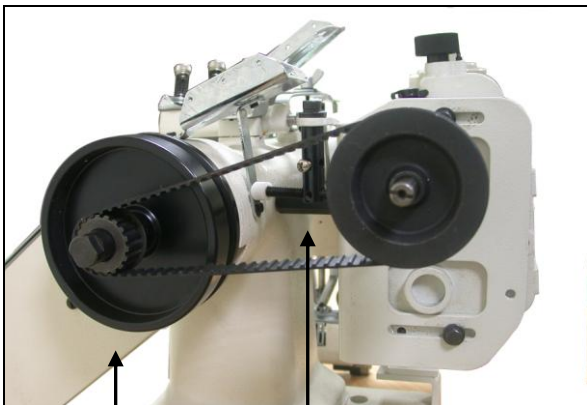

時規皮帶鬆緊固定螺絲，可依所需調整皮帶鬆緊  
Timing belt tightening screw

- ③ 調整固定皮帶蓋後加上外蓋  
Installing the belt covering

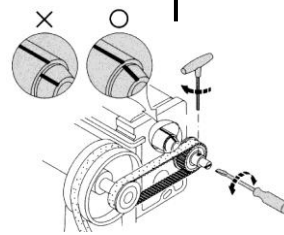
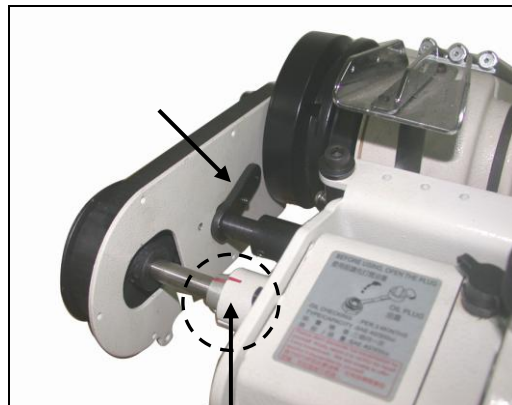

變速機的紅線對齊入立軸紅線後，上緊時規齒輪螺絲  
Meet the both red line on transmission input shaft, tighten the timing gear screw

### 入力軸定位

#### Adjust input shaft position

一般針車定位時，  
針車提升至最高點  
General type, needle to the toppest position

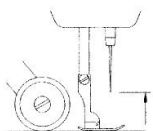

針送針車定位時，  
針車下降至最低點  
Needle feed type, needle to the lowest position

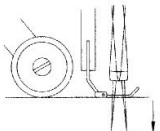

# 接線圖 WIRING DIAGRAM

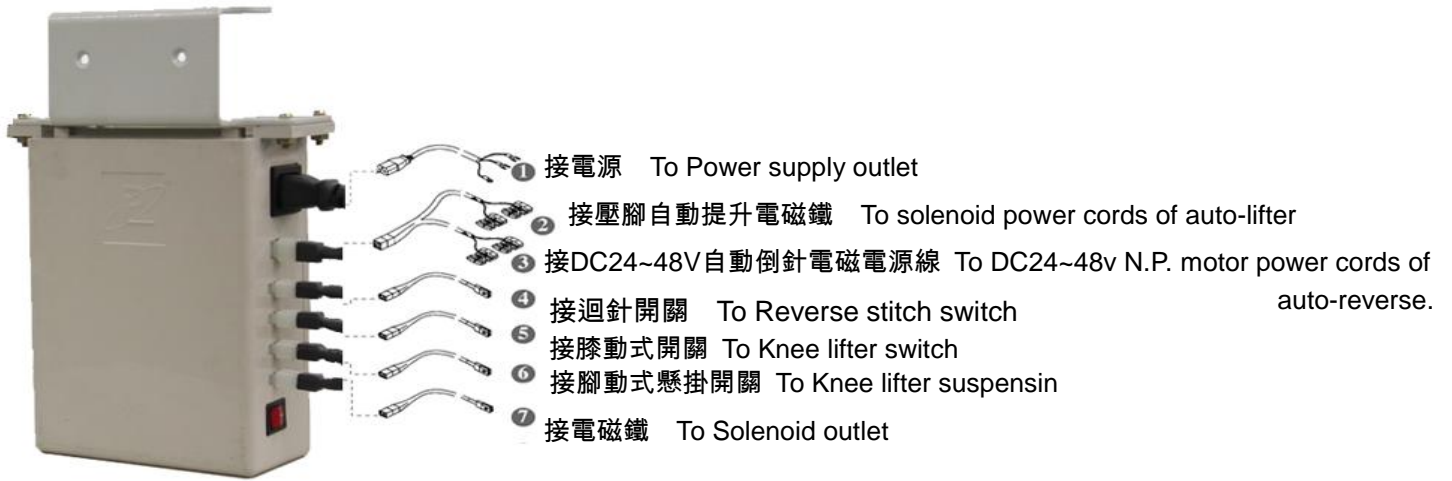

**1** 電源線及地線(電源：AC100V~220VC)  
power cords and earth terminal  
(AC100V~220VC power source)

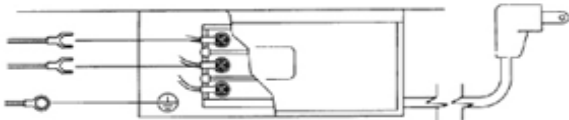

**2** 接壓腳自動提升電磁鐵電源線

To solenoid power cords of auto-lifer

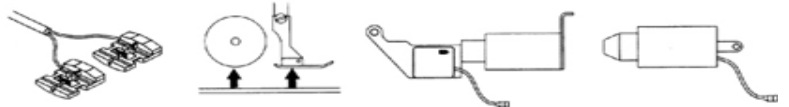

**3** 接於自動切線針車倒針用電磁電源上(DC24~48V)

Finding and connecting the power cords of auto-reverse solenoid(DC24~48V)

無自動切線之針車此線無需使用並將蓋子蓋上

For nonautomatic-trimming machine,keep this wire connector

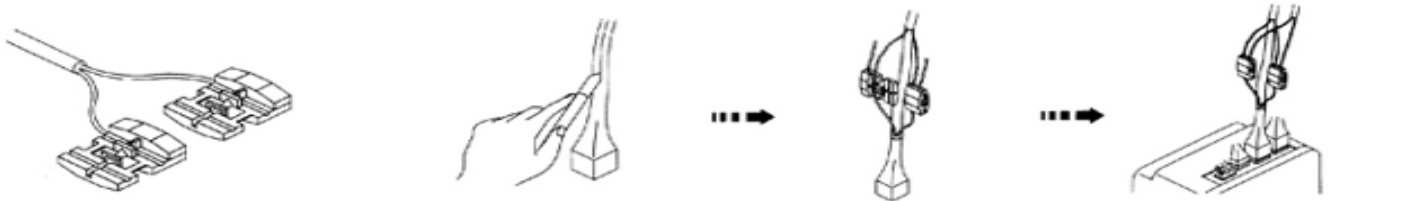

**4** 迴針開關  
Microswitch for reverse lever

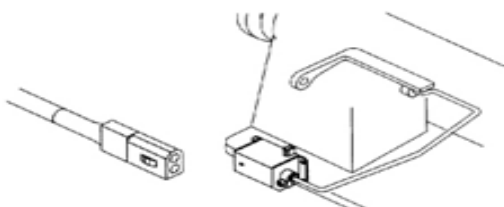

**5** 膝動開關  
Microswitch for knee presser foot lifter

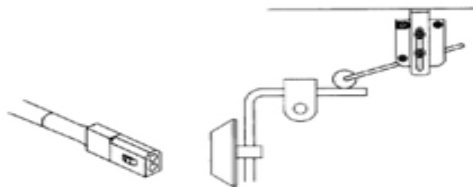

**6** 懸吊式開關  
Suspension microswitch

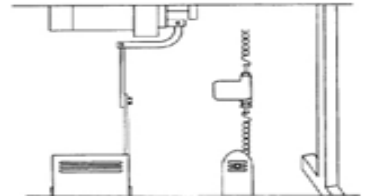

**7** 電磁鐵  
Solenoid

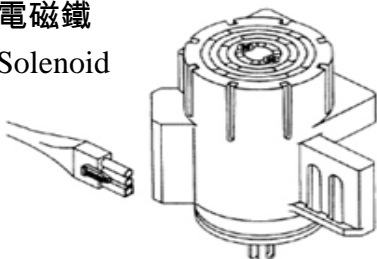

# HPF

