

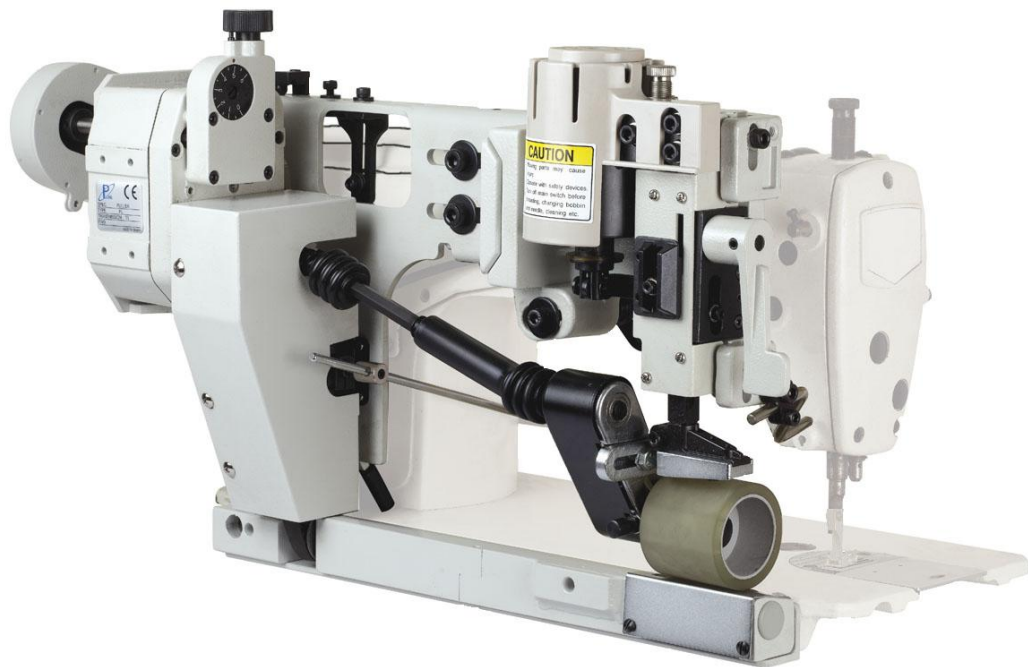

HPT 單針/雙針車用拖輪安裝手冊

THE INSTRUCTION GUIDE BOOK FOR HPT PULLER



安裝前,請詳細閱讀安裝說明書

PLEASE READ INSTRUCTIONS & ASSOCIATED DRAWINGS BEFORE INSTALLATION

皮帶輪螺栓
Studs for pulleys

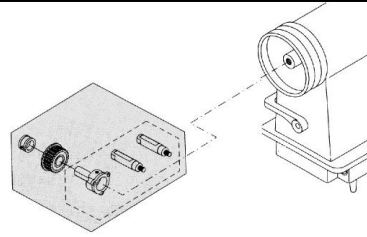

本體與連接桿(a)固定
Joins to connecting rod (a)

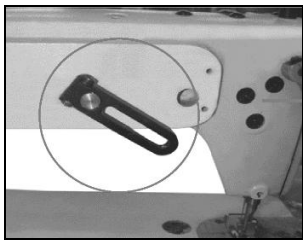

下輪座固定架(b)
Bracket for lower roller plate (b)

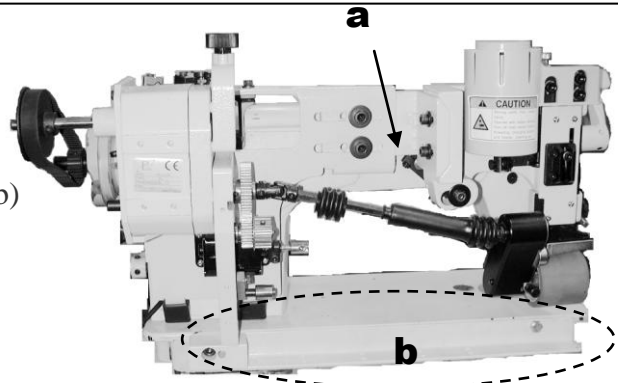
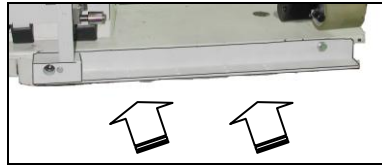

下輪座固定
Install the lower roller plate

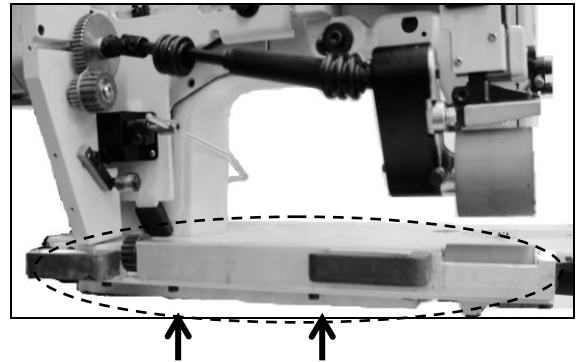

時規皮帶鬆緊固定螺絲，可依所需調整皮帶鬆緊
Timing belt tightening screw.

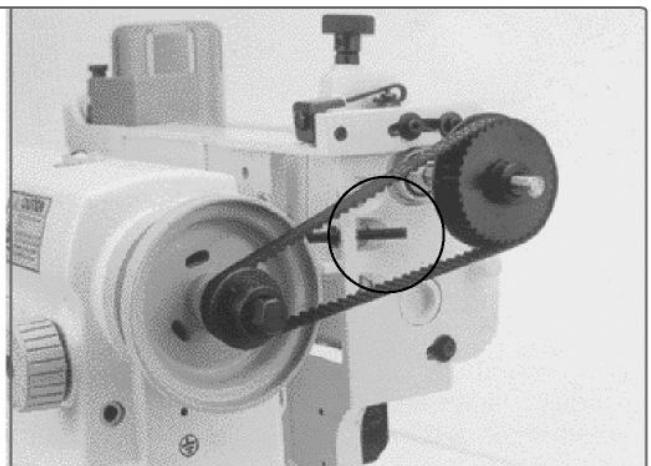
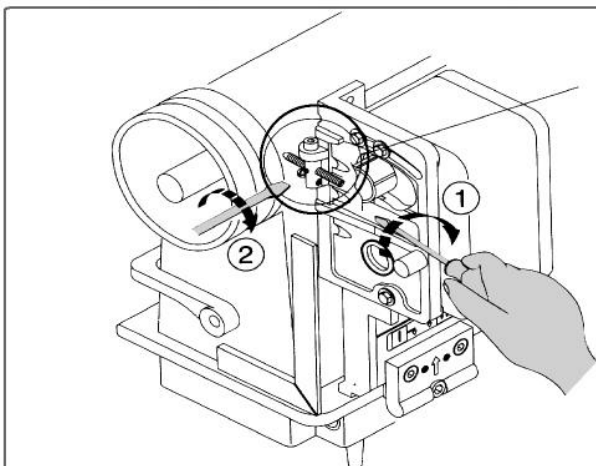

入力軸定位 Adjust input shaft position

一般針車定位時，
針車提升至最高點
General type, needle
to the toppest position

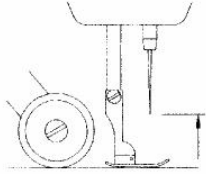

針送針車定位時，
針車下降至最低點
Needle feed type, needle
to the lowest position

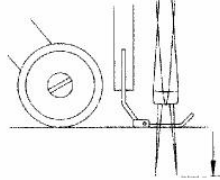

變速機的紅線對齊入力軸紅線後，上緊時規齒輪螺絲
Meet the both red line on transmission input shaft,
tighten the timing gear screw

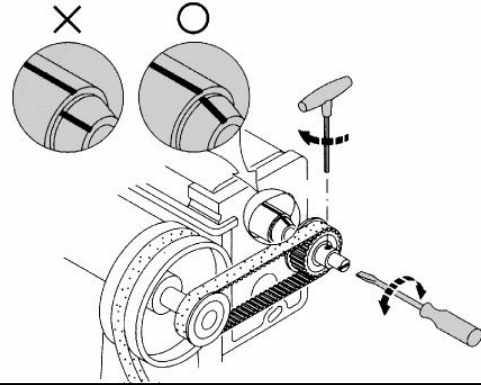

皮帶蓋安裝固定螺絲 Safety belt cover adjustment screws

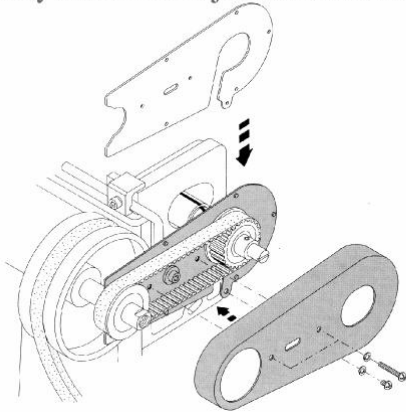

安全扣 Machine rest latch for maintenance

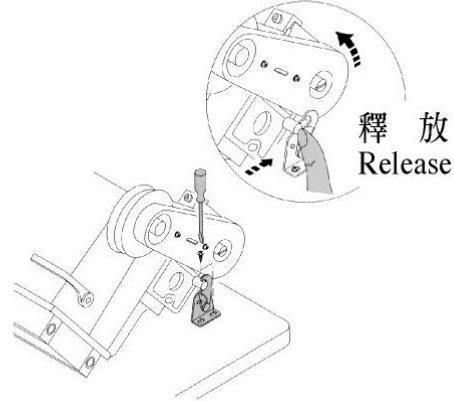

配合針車送料調整 Feeding adjustment

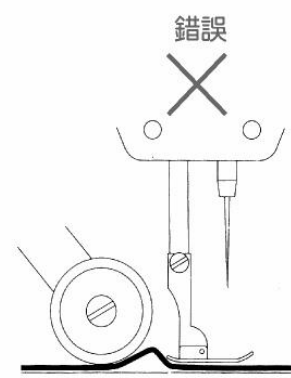
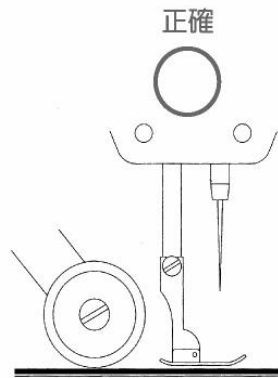
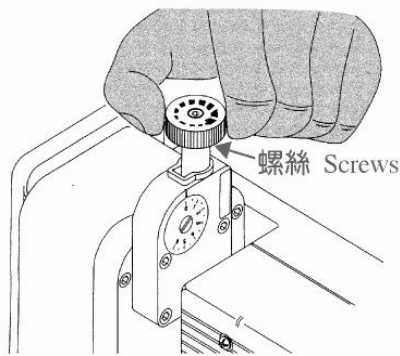

時規皮帶調整 Adjust tension of timing belt



下輪皮帶蓋固定 Installing the belt covering



接線圖 WIRING DIAGRAM

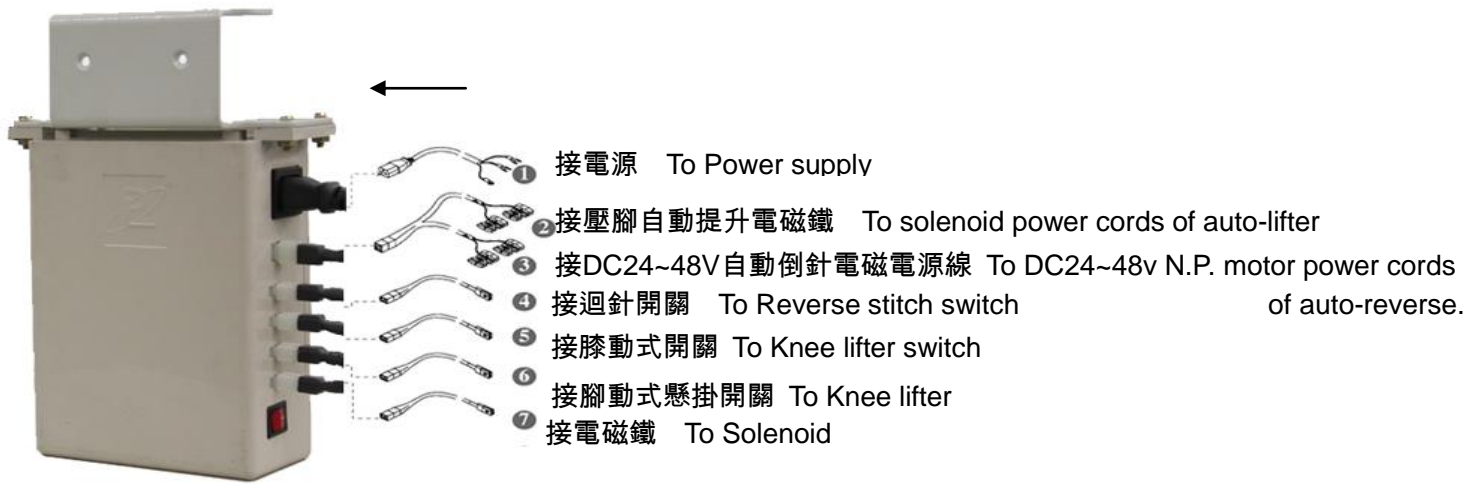

1 電源線及地線(電源：AC100V~220VC)
power cords and earth terminal
(AC100V~220VC power source)

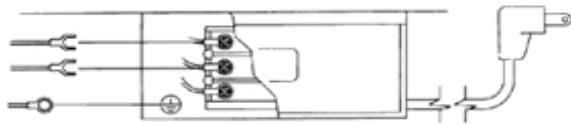

2 接壓腳自動提升電磁鐵電源線
To solenoid power cords of auto-lifer

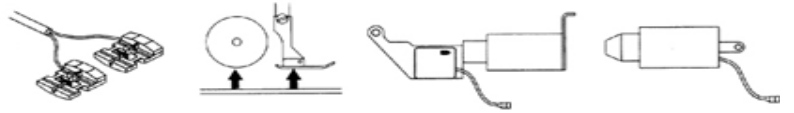

3 接於自動切線針車倒針用電磁電源上(DC24~48V)
Finding and connecting the power cords of auto-reverse

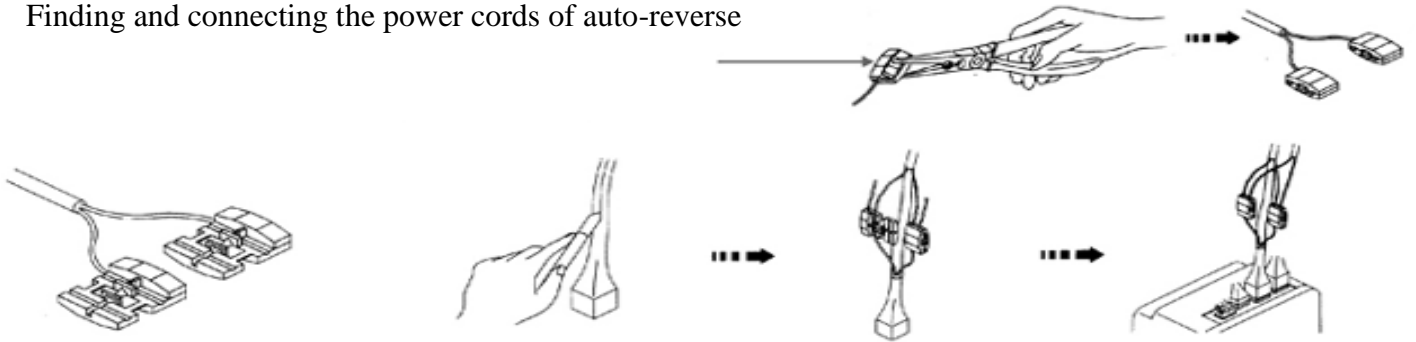

4 迴針開關
Microswitch for reverse lever

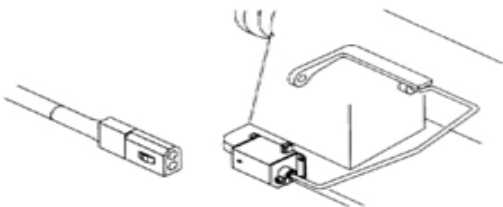

5 膝動開關
Microswitch for knee presser foot lifter

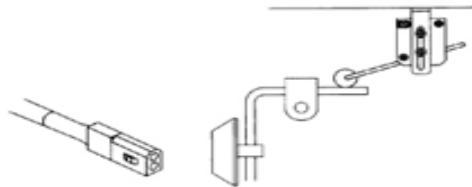

6 懸吊式開關
Suspension microswitch

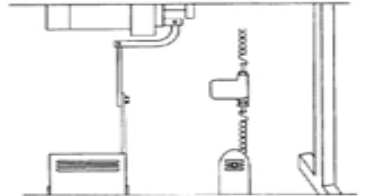

7 電磁鐵
Solenoid

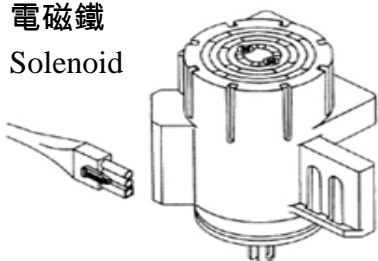

HPT

PULLER ATTACHMENT EXPLODED VIEW

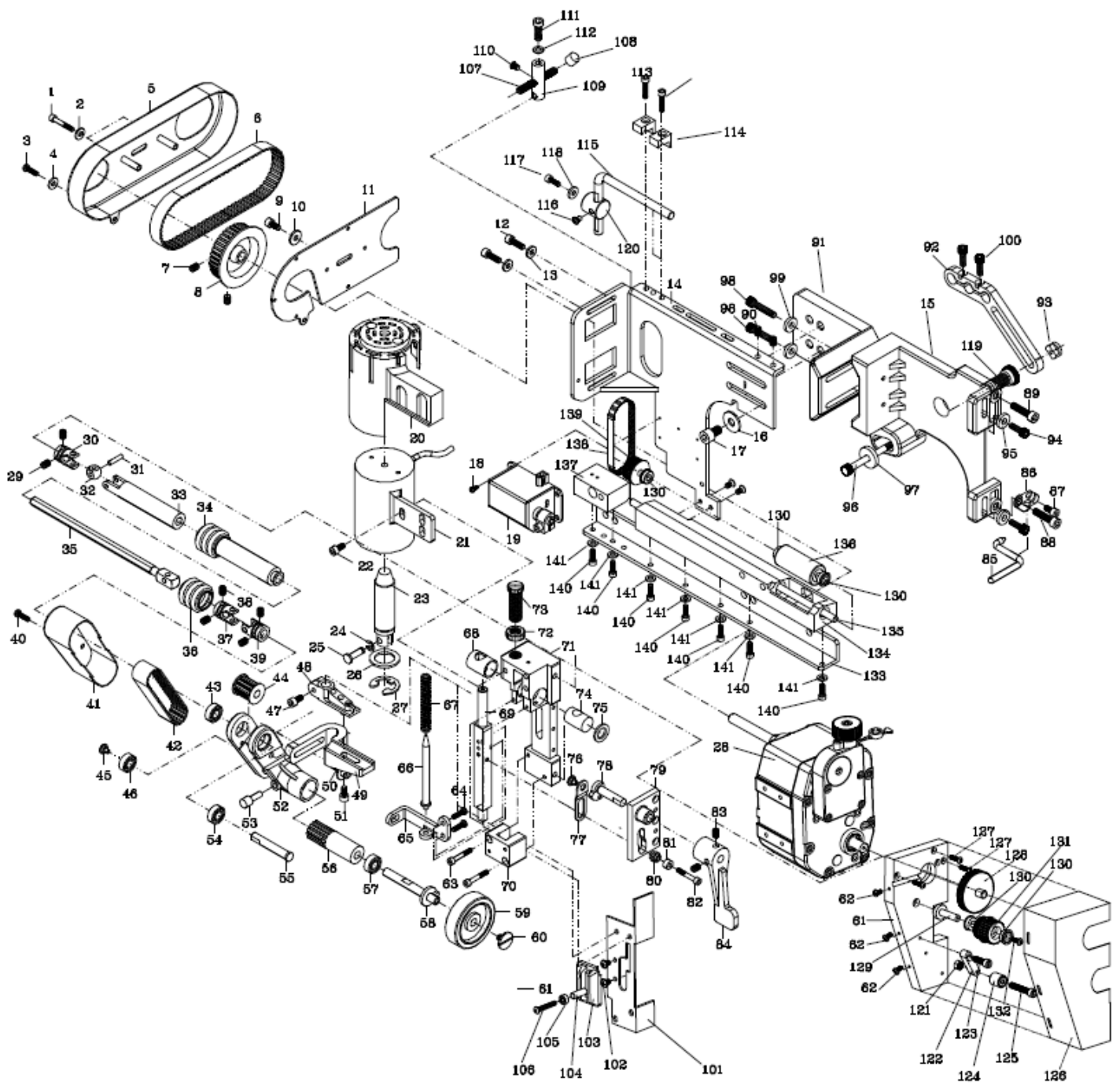

指示部外一般公差表	公差
尺寸範圍	公差
1-4	±0.1
4-16	±0.2
16-63	±0.3
63-250	±0.5
250-1000	±0.8

項目	更改內容	記號	核准	日期

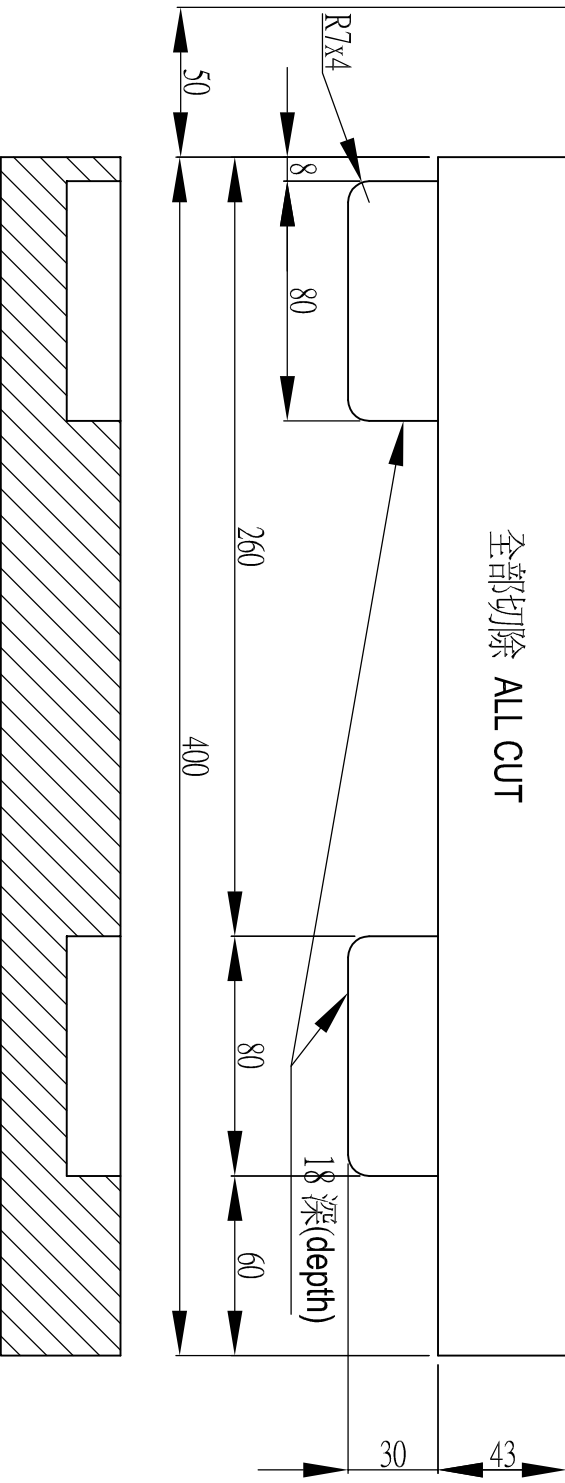

機種	
品名	
零件號	
設計	繪圖
審核	核准
比例	單位
數量	日期
1	MM

素材	
材質	
硬度	
熱處理	
表面處理	

注意事項：
未標註R角：
未標註C角：

指示部外一般公差表	公差
尺寸範圍	公差
1-4	±0.1
4-16	±0.2
16-63	±0.3
63-250	±0.5
250-1000	±0.8

項目	更改內容	記號	核准	日期

千鳥車 ZIG-ZAG

全部切除 ALL CUT

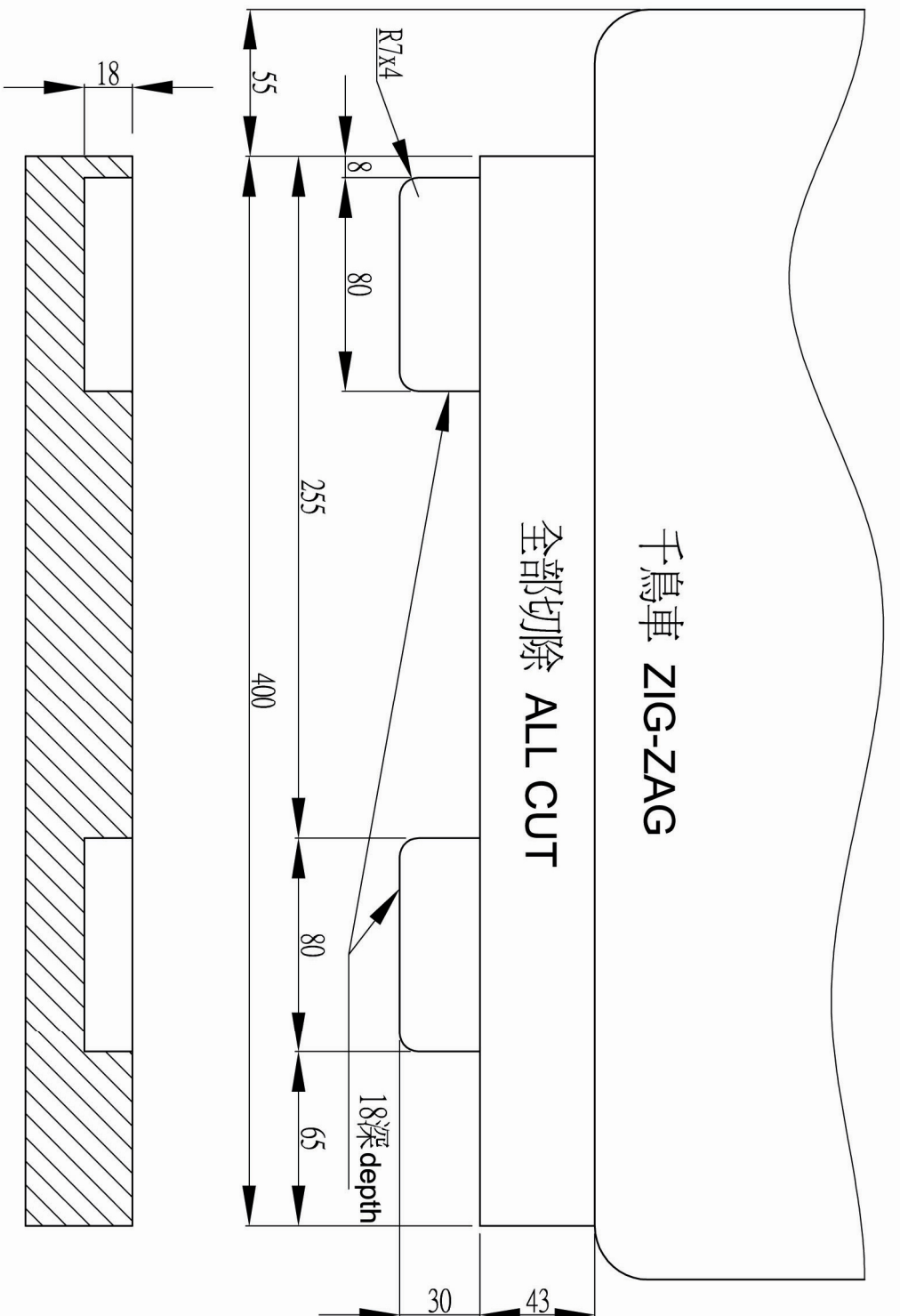

機種	
品名	
零件號	HG-97090101
設計	繪圖
審核	核准
比例	1:1
數量	1
日期	2008/09/01

素材	?
材質	
硬度	
熱處理	
表面處理	

注意事項:
未標註倒角:
未標註C角: